



D 201 RH
D 201 RHS
D 201 RHG
D 201 RHGS

D 250 RMS
D 250 RHGS

D 300 RM/RMA
D 300 RH/RHA



D 250 / 300 R



D 201 R



www.ausa.com

AUSA Center, S.L. ● Ctra. de Vic, Km 2.8 - P.O.B. 194. 08243 Manresa - BARCELONA (ESPAÑA) Tel.: +34 93 874 73 11 - E-mail: ausa@ausa.com

ISO 9001 ISO 14001



(Sede central AUSA-Manresa)

AUSA Madrid ● Pol. Ind. Coslada - C. Marconi 15-17. 28823 Coslada - MADRID (ESPAÑA) Tel.: +34 91 669 00 06 - E-mail: ausa.madrid@ausa.com
AUSA France ● Z. I. Saint Charles - Rue de Zürich, 66000 PERPIGNAN (FRANCE) Tel.: +33 (0) 4 68 54 38 97 - E-mail: ausa.france@ausa.com
AUSA Deutschland ● Heinrich - Welken Str. 5. 59069 HAMM (GERMANY) Tel.: +49 (0) 2384-9889905 - E-mail: ausa.deutschland@ausa.com
BEIJING Rep. Office ● Address Room 527. HengXiang Building, Tuanjiehu Nanli, Chaoyang District. - BEIJING 100026 (CHINA)
 Tel.: 86-10-8597 1983 - Fax: 86-10-8597 1993 - E-mail: ausa.china@ausa.com

AUSA UK ● Tel.: 07970639988 - E-mail: ausa.uk@ausa.com

AUSA Brasil ● Tel.: +55 51 33622111 - E-mail: ausa.brasil@ausa.com

AUSA México ● Calzada Vallejo, 725. 07750 Del. Gustavo A. Madero, México D.F. (MÉXICO) Tel.: +55 2166-9066 - E-mail: ausa.mexico@ausa.com



D 201 RH/S_2000 Kg
D 201 RHG/S_2000 Kg
D 250 RMS_2500 Kg
D 250 RHGS_2500 Kg
D 300 RM/RMA_3000 Kg
D 300 RH/RHA_3000 Kg

| DIMENSIONS (mm) | D 201 RH/S | D 201 RHG/S | D 250 RMS | D 250 RHGS | D 300 RM/RMA | D 300 RH/RHA |
|-----------------|-------------|-------------|-----------|------------|--------------------|--------------------|
| A | 1565 | 1540 | 1700 | 1520 | 1840 / 1700 | 1840 / 1700 |
| B | 1445 | 1545 | 1560 | 1605 | 1632 / 1680 - 2390 | 1632 / 1680 - 2390 |
| C | 1590 / 1750 | 1590 / 1750 | 1800 | 1800 | 1800 | 1800 |
| D | 185 | 185 | 200 | 200 | 200 | 200 |
| E | 1195 | 1295 | 1305 | 1445 | 1380 / 1475 - 2175 | 1380 / 1475 - 2175 |
| F | 2580 | 2580 | 2240 | 2240 | 2240 | 2240 |
| G | 255 | 255 | 350 | 350 | 350 | 350 |
| H | 885 | 925 | 807 | 842 | 993 / 762 | 993 / 762 |
| I | 1640 | 1640 | 1730 | 1730 | 1730 | 1730 |
| J | 715 | 715 | 500 | 500 | 500 | 500 |
| K | 3020 | 3280 | 3044 | 2980 | 3231 / 2992 | 3231 / 2992 |
| L | 2245 | 2665 | 2550 | 2885 | 2580 / 3010 - 3705 | 2580 / 3010 - 3705 |
| M | 275 | 535 | 417 | 452 | 603 / 364 | 603 / 364 |
| N | 570 | 930 | 720 | 1105 | 570 / 1310 - 2020 | 570 / 1310 - 2020 |
| R | - / 2045 | - / 2045 | 2100 | 2100 | - | - |
| S | - / 3980 | - / 3980 | 4174 | 4174 | - | - |
| T | 1590 | 1590 | 1700 | 1700 | 1700 | 1700 |
| U | - | 215 | - | 100 | - | - |

S : Dumper equipped with self-loading shovel

V: maximum visibility with the shovel fully retracted (patented system)

AUSA
www.ausa.com

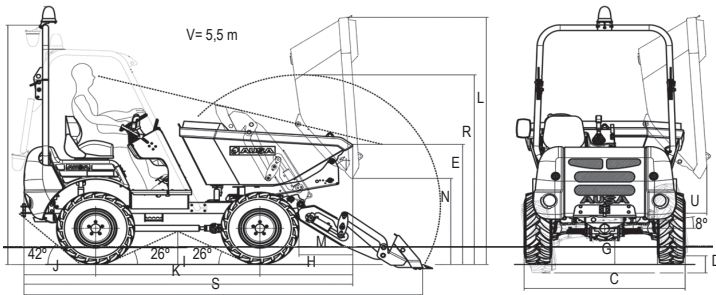

D 250 RMS - D 250 RHGS - D 300 RM / RMA - D 300 RH / RHA

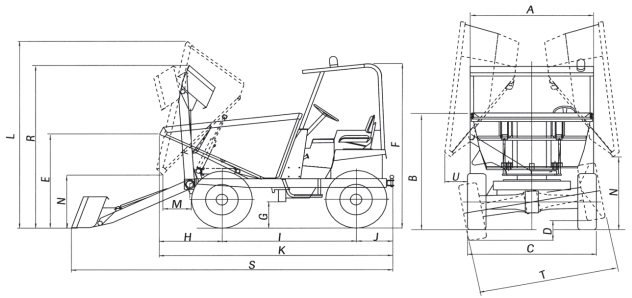

TECHNICAL SPECIFICATIONS

| | D 201 RH / S | D 201 RHG / S | D 250 RMS | D 250 RHGS | D 300 RM / RMA | D 300 RH / RHA |
|---|--|--------------------------|---|--|--|---|
| Load capacity (Kg) | 2000 | | 2500 | | 3000 | |
| Unloading system | Frontal hydraulic | Hydraulic, 180° rotating | Frontal tipping with self-loading shovel | 180° rotating tipping with frontal self-loading shovel | Frontal tipping / High tipping | Frontal tipping / High tipping |
| Chassis | Rigid | | | | | |
| Hopper capacities (l) | Water | 700 | 650 | 900 | 850 | 1290 / 1000 |
| | Levelled | 960 | 930 | 1315 | 950 | 1800 / 1335 |
| | Heaped | 1250 | 1230 | 1500 | 1200 | 1950 / 1600 |
| Engine | Diesel | KUBOTA V1505 | | LOMB. 9LD 626/2B2 NR | ISUZU 4LE2 | LOMB. 9LD 626/2B2 NR |
| | Power (KW/HP) | 22.7 / 30.8 (SAE J 1995) | | 17.5 / 23.8 (DIN 70020) | 38/51.7 (SAE J1995) | 17.5/23.8 (DIN 70020) |
| | N° of Cylinder | 4 | | 2 | 4 | 2 |
| | Cooling system | Water | | Air | Water | Air |
| Drive | 4 x 4 permanent Compen® System | | D 300 RH / RHA = 4x4 permanent / other models 4x4 permanent Compen System | | | |
| Transmission | 2-speed hydrostatic Electric gear inverter on the joystick | | Mechanical, with 4 forward gears and 4 reverse | 2-speed hydrostatic Electric gear inverter | Mechanical, with 4 forward gears and 4 reverse | 2 - hydrostatics speeds - Electric gear inverter |
| Clutch | - | | Dry single-disc diam. 254 mm - Mechanical driven | - | Dry single-disc diam. 254 mm - Mechanical driven | - |
| Engine starting system | Eléctric | | | | | |
| Speed (max.) (Km/h) | 20 | | | | | |
| Unladen weight (Kg) | 1600 / 1800 | 1850 / 2050 | 1970 / 2170 | | 2000 / 2130 | 2000 / 2130 |
| Gradeability | 42% | | 35% | 42% | 32% | |
| Hydraulic circuit | Gear pump of 8 cc Working pressure 190 bar | | Gear pump of 10.6 cc. Working pressure 150 bar | | | |
| Tyres | Front | 10.0/75-15.3 (10 PR) | | | | Working pressure 160 bar |
| | Rear | 10.0/75-15.3 (10 PR) | | | | |
| External turning radius (mm) | 4190 | | 4500 | | | |
| Steering | Hydraulic. Working pressure 80 bar. | | Hydraulic. Working pressure 70 bar. | | | |
| Tank capacity (l) | Fuel | 40 | | | | 30 |
| | Hydraulic fluid | 40 | | | | 30 |
| Service brake | Sealed oil-immersed multidisc | | Oil-immersed, multidisc, hydraulically operated | Hydraulic, drum-type, on front driving shaft | Oil-immersed, multidisc, hydraulically operated | Hydraulic, drum-type, on front driving shaft |
| Parking brake | Sealed oil-immersed multidisc | | Mechanical, drum-type, on front driving shaft. | | | |
| STANDARD EQUIPMENT | Anti vandal system | | | | | |
| | Audible reverse warning | | | | | |
| | Ergonomic seat (with seat belt when ROPS option) | | | | | |
| | ROPS protection | | - | | | |
| | Rotating beacon | | - | | | |
| | Rear view mirror | | - | | | |
| Self-loading shovel * Volumetric capacity | 180 l. | | 250l. | | - | |
| * (only RHS/RHGS models) | | | | | | |
| OPTIONAL EQUIPMENT | Closed cabin | | - | | | |
| | Front windscreen with wiper | | | | | |
| | Second seat | | | | | |
| | FOPS/ROPS | | | | | |
| | FOPS/ROPS protective roof (Seat belt, rotating beacon, rear view mirror) | | | | | |
| | Homologated lighting equipment | | | | | |
| | Towing hitch | | | | | |
| Back-hoe (only in self-loading shovel version) | - | | Maximum digging deep: 2750 mm. Break out power: 3970 kg. Transportation height: 2250 mm. Fast-attach system of the backhoe to the dumper. Operating site: 360° rotating seat. Weight: 900 Kg. | | | |